

**25th SIDEROAD AND 9TH LINE - ROUNDABOUT CONCEPT DESIGN
ALTERNATIVE 1 - ICD = 28m**

**SCALE: 1:250
DATE: JANUARY 12, 2022**

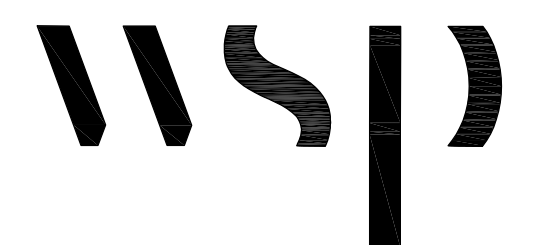

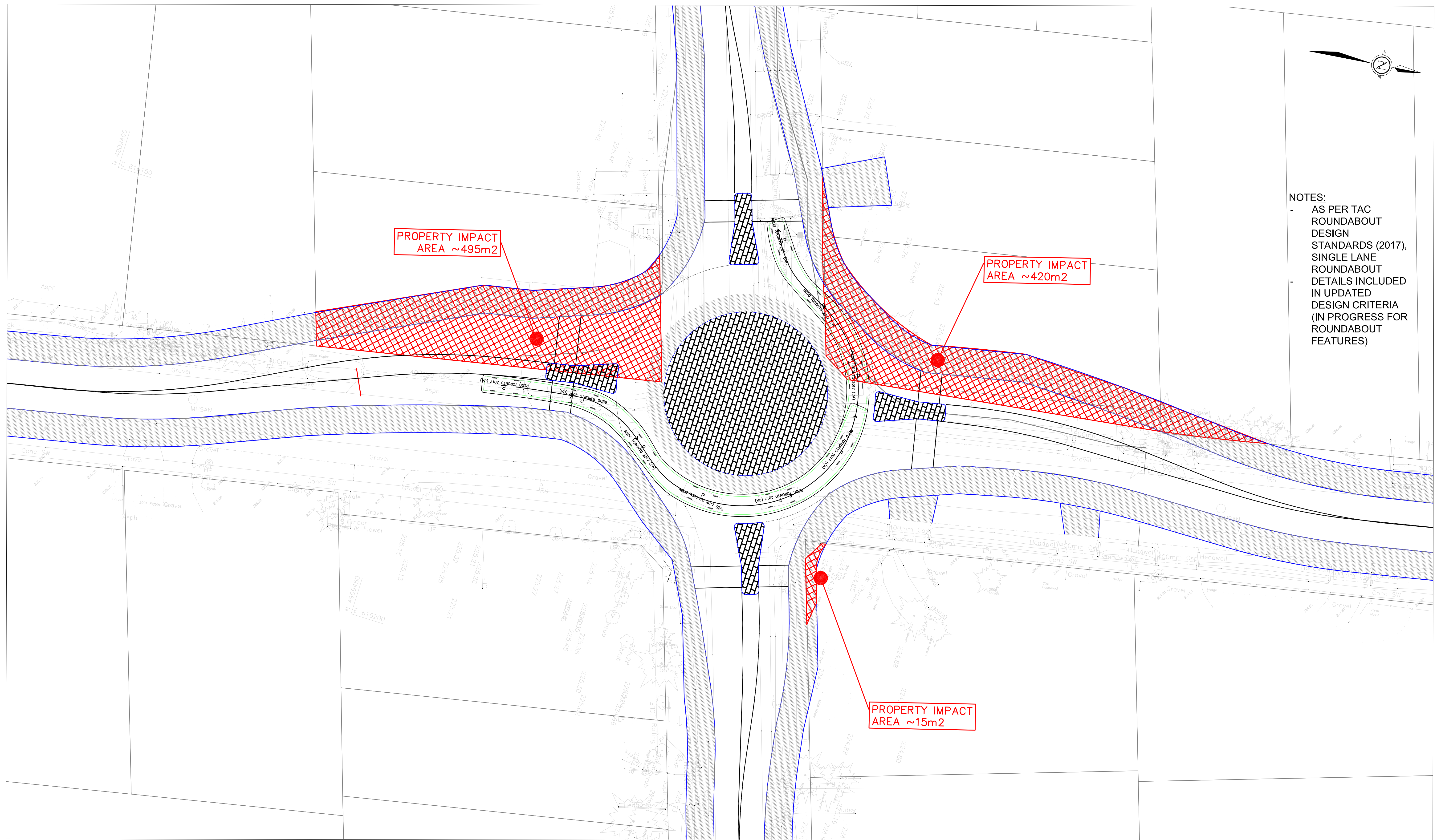

NOTES:
 - AS PER TAC
 ROUNDABOUT
 DESIGN
 STANDARDS (2017),
 SINGLE LANE
 ROUNDABOUT
 DETAILS INCLUDED
 IN UPDATED
 DESIGN CRITERIA
 (IN PROGRESS FOR
 ROUNDABOUT
 FEATURES)

**25th SIDEROAD AND 9TH LINE - ROUNDABOUT CONCEPT DESIGN
 ALTERNATIVE 1 - PASSENGER TURNING ANALYSIS**

**SCALE: 1:250
 DATE: JANUARY 12, 2022**

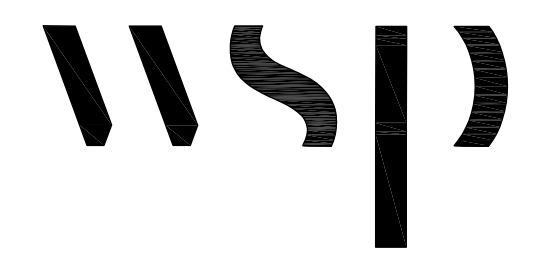

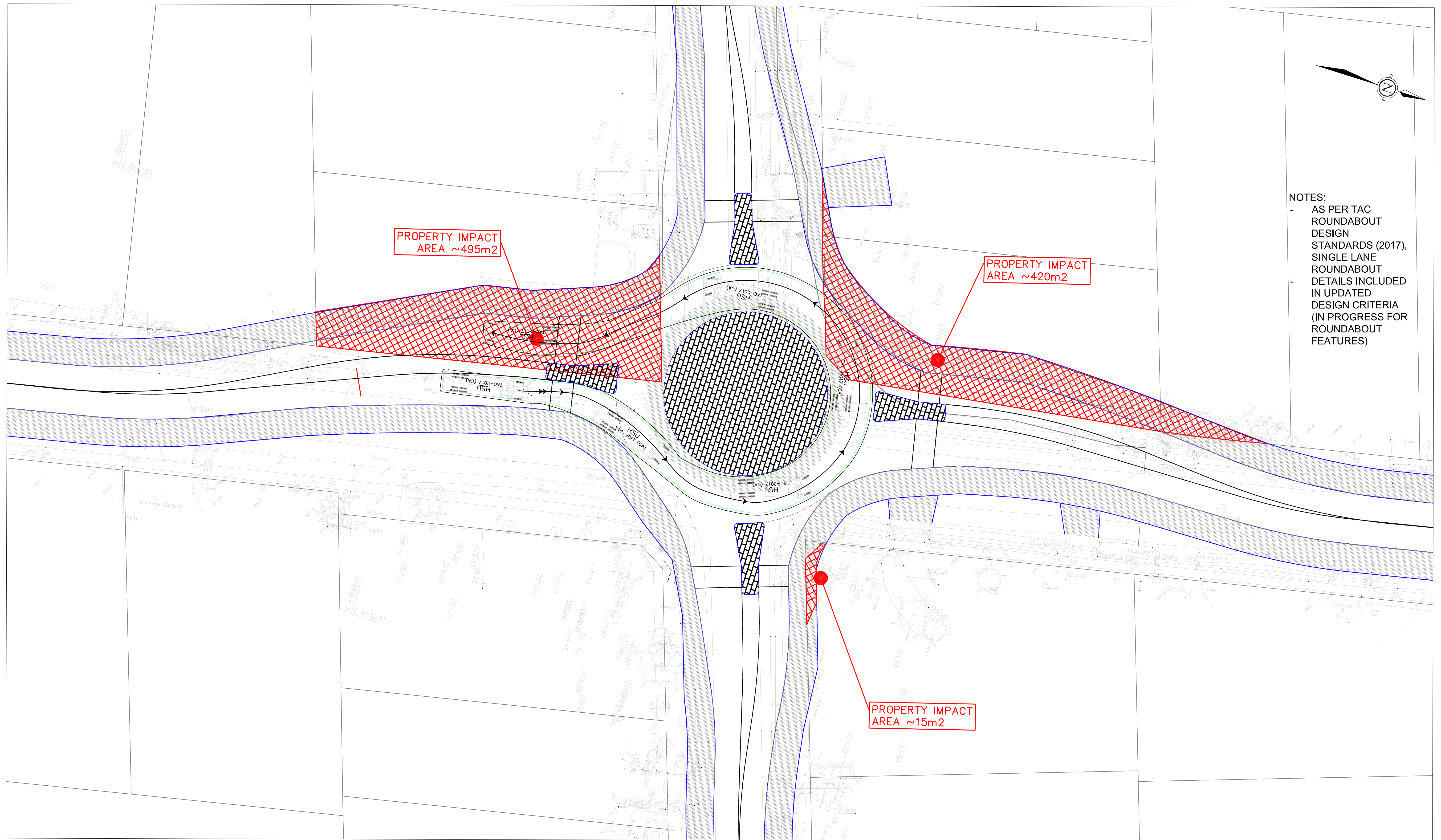

NOTES:
 - AS PER TAC
 ROUNDABOUT
 DESIGN
 STANDARDS (2017),
 SINGLE LANE
 ROUNDABOUT
 DETAILS INCLUDED
 IN UPDATED
 DESIGN CRITERIA
 (IN PROGRESS FOR
 ROUNDABOUT
 FEATURES)

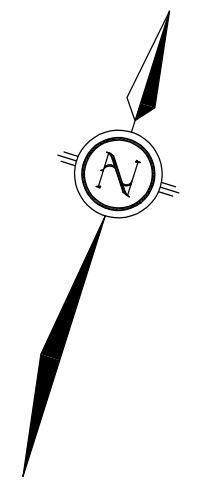
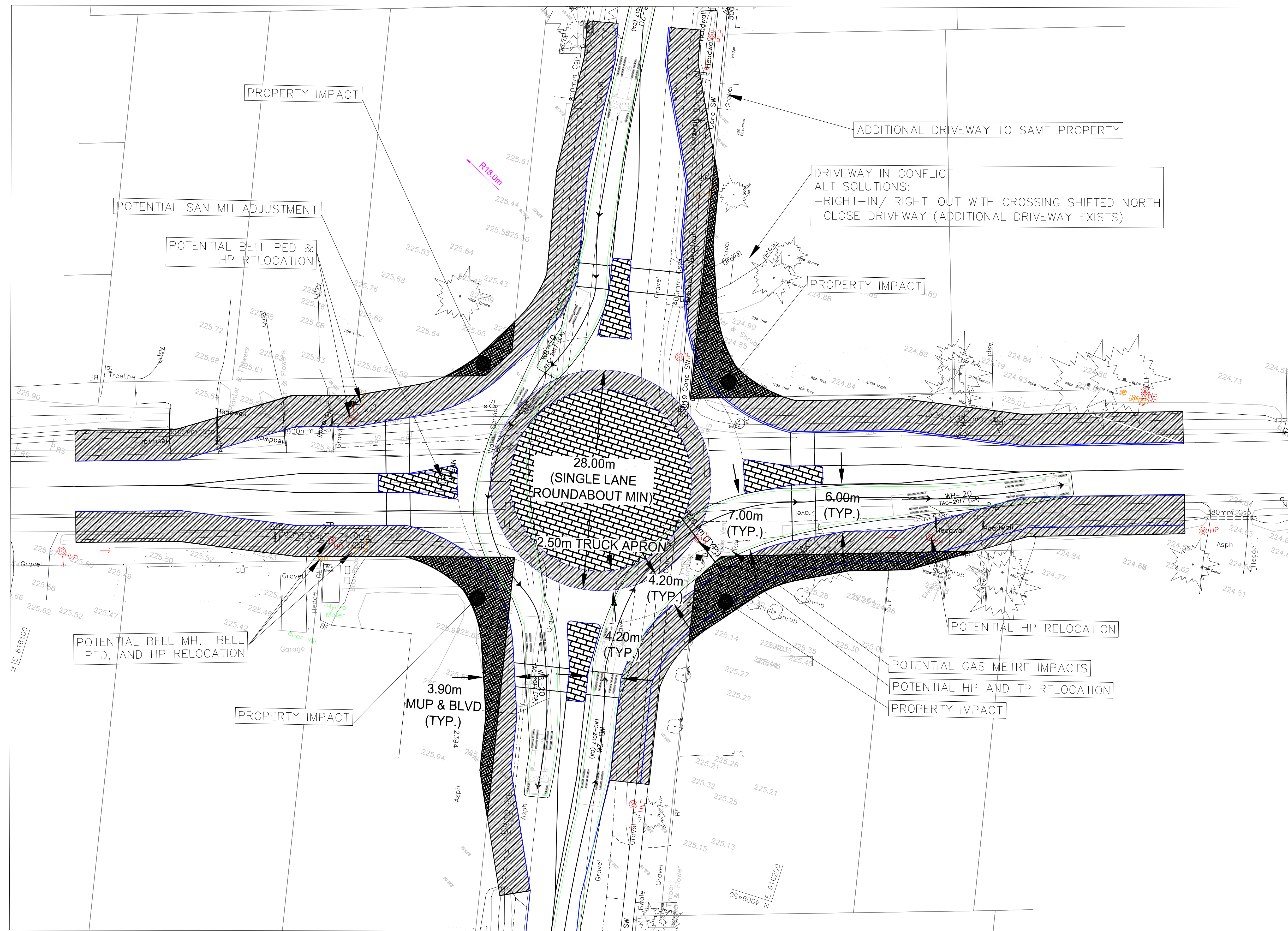

- NOTES:**
- AS PER TAC ROUNDABOUT DESIGN STANDARDS (2017), SINGLE LANE ROUNDABOUT
 - DETAILS INCLUDED IN UPDATED DESIGN CRITERIA (IN PROGRESS FOR ROUNDABOUT FEATURES)

**25th SIDEROAD AND 9TH LINE - ROUNDABOUT CONCEPT DESIGN
ALTERNATIVE 1 - WB20 TURNING ANALYSIS**

**SCALE: 1:250
DATE: APRIL 20, 2022**



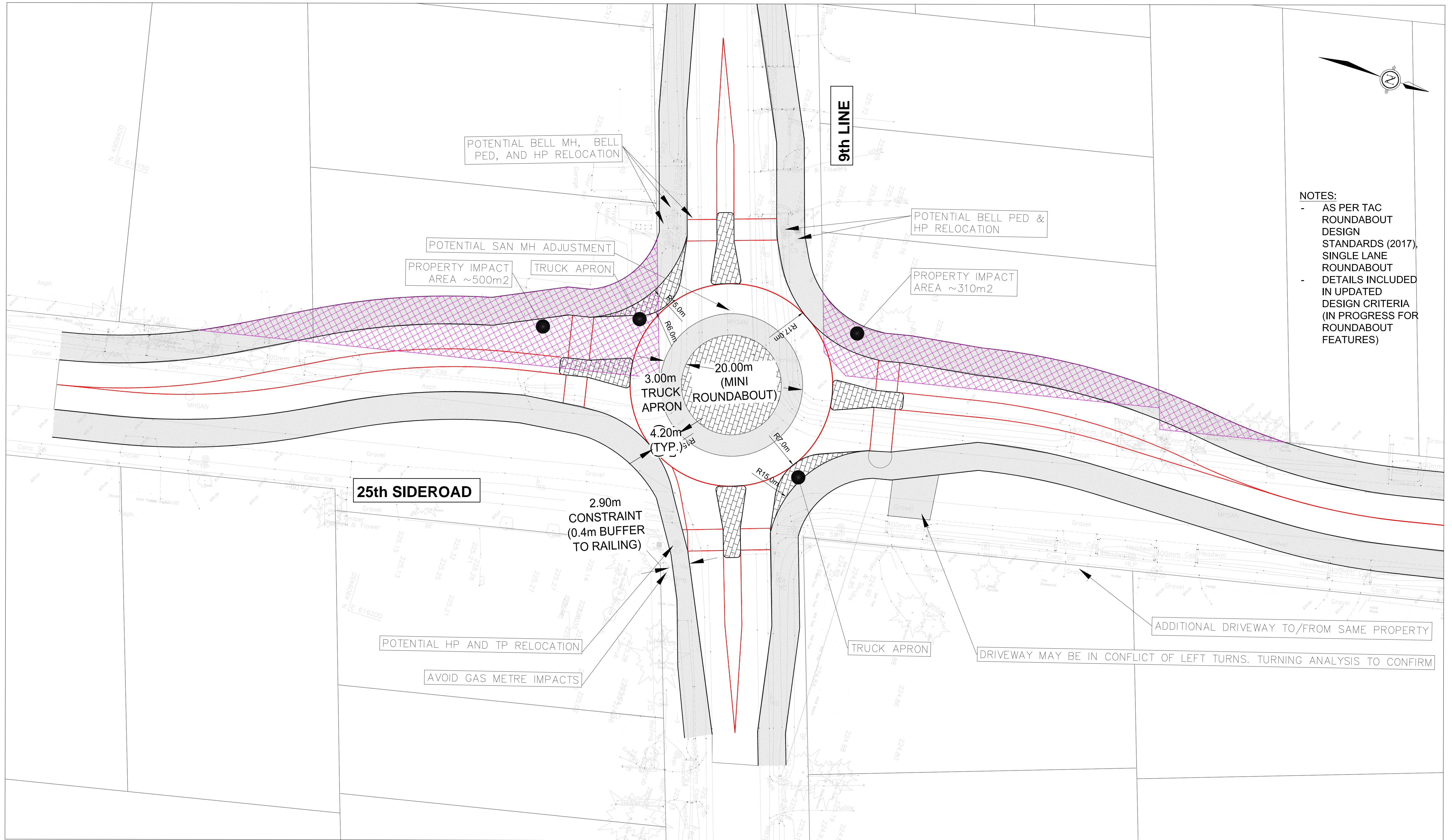

- NOTES:**
- AS PER TAC ROUNDABOUT DESIGN STANDARDS (2017), SINGLE LANE ROUNDABOUT DETAILS INCLUDED IN UPDATED DESIGN CRITERIA (IN PROGRESS FOR ROUNDABOUT FEATURES)

25th SIDEROAD AND 9TH LINE - ROUNDABOUT CONCEPT DESIGN
ALTERNATIVE 2a - ICD = 20m

SCALE: 1:250
DATE: JANUARY 12, 2022



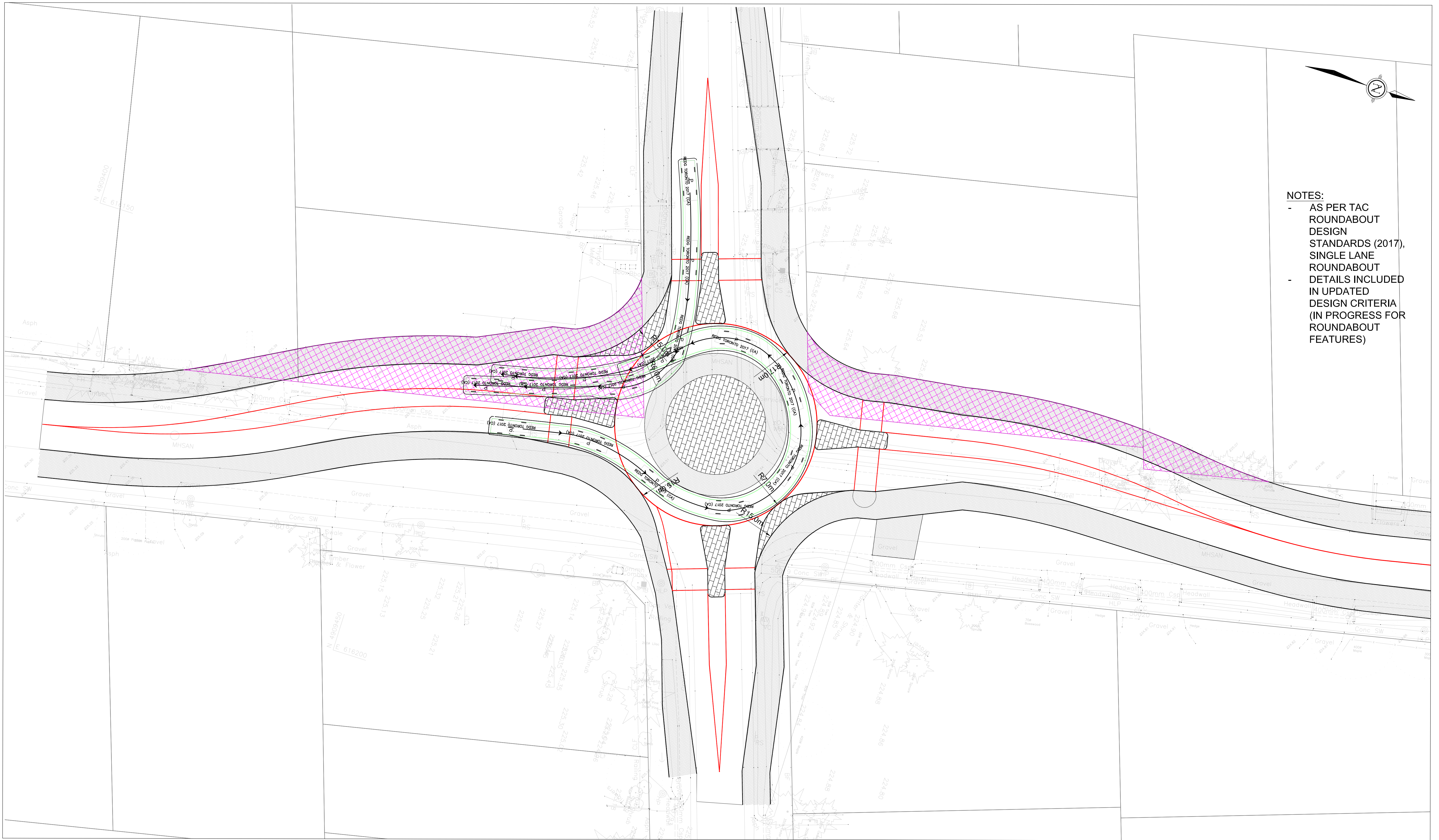

- NOTES:**
- AS PER TAC ROUNDABOUT DESIGN STANDARDS (2017), SINGLE LANE ROUNDABOUT
 - DETAILS INCLUDED IN UPDATED DESIGN CRITERIA (IN PROGRESS FOR ROUNDABOUT FEATURES)

**25th SIDEROAD AND 9TH LINE - ROUNDABOUT CONCEPT DESIGN
ALTERNATIVE 2a - PASSENGER TURNING ANALYSIS**

**SCALE: 1:250
DATE: JANUARY 12, 2022**



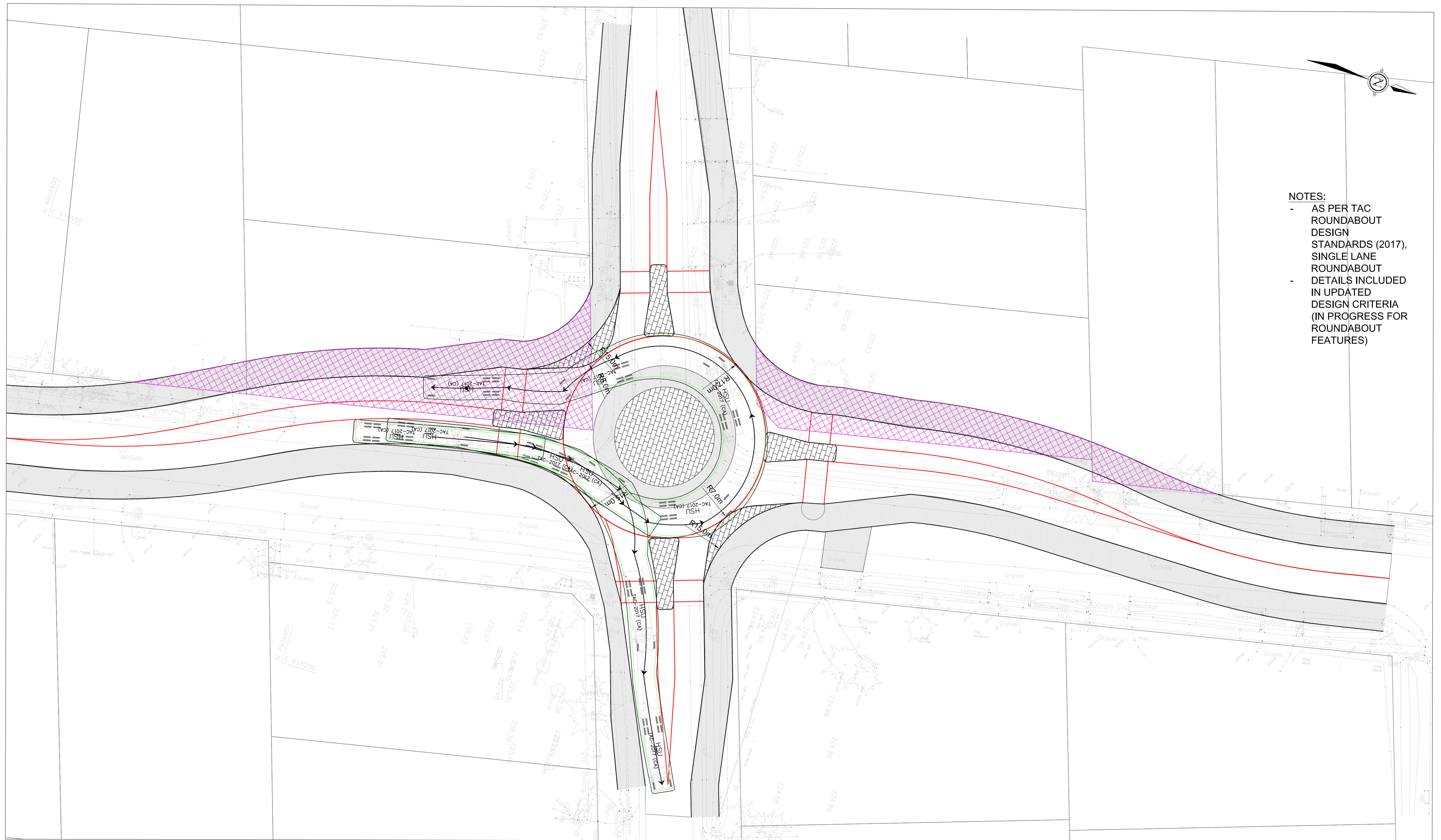

- NOTES:**
- AS PER TAC ROUNDABOUT DESIGN STANDARDS (2017), SINGLE LANE ROUNDABOUT
 - DETAILS INCLUDED IN UPDATED DESIGN CRITERIA (IN PROGRESS FOR ROUNDABOUT FEATURES)

**25th SIDEROAD AND 9TH LINE - ROUNDABOUT CONCEPT DESIGN
ALTERNATIVE 2a - HSU TURNING ANALYSIS**

**SCALE: 1:250
DATE: JANUARY 12, 2022**

